



STAINLESS STEEL & PYRAGRANITE SINKS

KITCHEN TAPS, WASTE DISPOSER

OVENS, COOKERHOODS

UAE PRODUCT BROCHURE 2023





Tireless, we are always looking ahead

Pyramis Metallourgia A.E. is a Greek company that produces and trades in integrated kitchen and bathroom solutions. It was started as a family business in 1960 by Alexandros Bakatselos, and today it is one of the largest stainless steel sink producers in the world, with powerful strategic partnerships globally. It has its headquarters in Thessaloniki, where its factory is based, a true achievement for Greek standards, as it is one of the largest stainless steel production units in the world. In 2013 operations began at a new granite and synthetic sink plant in Kilkis.

Technological excellence

Pyramis Metallourgia A.E. is located in Liti Thessalonikis, where its highly automated production facilities of stainless steel sinks, distribution center and head offices are based. In 2013, the new granite and synthetic sinks production facility started its operations with an annual capacity of 170.000 sinks. The evolutionary course of PYRAMIS is due to the continuous investments in both technological and mechanical equipment, to the successful development and launch of new innovative products and to the know-how and specialization of its human resources.

PYRAMIS worldwide

Greek and global, PYRAMIS has set up 9 subsidiaries in Poland, the UK, Germany, Romania, Italy, Russia, Bulgaria, UAE, and the Czech Republic. In Greece it is a leader in the Kitchen and Bathroom sector, with products that Greek consumers trust.



Stainless Steel Sinks

PYRAMIS uses traditionally the best quality performance Stainless Steel material AISI 304. This type of stainless steel contains a significant amount of chromium, and sufficient nickel to «stabilise» the microstructure, that gives to these steel goods formability and ductility. The typical composition is 18% chromium and 10% nickel and this makes PYRAMIS' Stainless Steel Sinks extremely resistant to rust or corrosion in normal household conditions.

Kitchen Solutions

Kitchen is the room where we share beautiful moments and smiles with our loved ones daily. Therefore, it needs to be stylish, functional and should follow high quality and safety standards. In PYRAMIS we offer integrated solutions, from contemporary kitchen sinks and mixers, to high quality electrical appliances, distinguished for both their design and quality. Thus, our kitchen area becomes truly unique.

Kitchen Products

- Stainless Steel Sinks
- Pyragranite Sinks
- Kitchen Mixers
- Cookerhoods
- Ovens
- Hobs
- Refrigerators





TABLE OF CONTENTS

| | |
|-------------------------------------|-------|
| Stainless Steel Sink Finish | 4 |
| Installation Profile | 4 |
| Jumbo Bowl Sinks | |
| Onset Type - Grando Series | 5 |
| Inset Type - Profondo Series | 5 |
| Undermount Type | |
| Iris Series | 6 |
| Lume Series | 6 |
| Lydia Series | 7 |
| Relia Series | 7 |
| Flushmount Type | |
| Lume Series | 6 |
| Lydia Series | 7 |
| Zeria Series | 8 |
| Inset Type | |
| Basic Series | 8 |
| Space Series | 9 |
| Tico Series | 9 |
| Corner Series | 10 |
| Athena Extra Series | 10 |
| Amaltia Series | 11 |
| Sparta Series | 11 |
| Titan Series | 12 |
| Bowl Series | 12 |
| Pyragranite Series | 13 |
| Onset Type | |
| International Series | 14 |
| SINK ACCESSORIES | 15 |
| KITCHEN TAPS | 16-17 |
| OVENS & REFRIGERATOR | 18 |
| GAS HOBS | 19 |
| CERAMIC & INDUCTION HOBS | 20-21 |
| COOKERHOODS | 22-23 |

Stainless Steel Sinks

Stainless steel finish

PYRAMIS uses traditionally the best quality performance Stainless Steel material AISI 304. This type of stainless steel contains a significant amount of chromium, and sufficient nickel to «stabilise» the microstructure, that gives to these steel goods formability and ductility. The typical composition is 18% chromium and 10% nickel and this makes PYRAMIS' Stainless Steel Sinks extremely resistant to rust or corrosion in normal household conditions. A variety of stainless steel finishes includes **polished**, **satin**, **brushed** and **linen**.

POLISHED

SATIN

BRUSHED

LINEN

Installation profiles

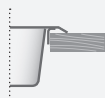

Inset

The rim of the sink sits on the worktop after installation.

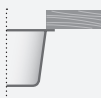

Undermount

The rim of the sink is placed underneath the worktop.



Flushmount

The rim of the sink is installed at exactly the same level with the worktop.

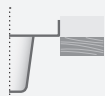

Onset - 3 Sides Down

Three of the four sides are folded down but the back edge side of the sink is folded up in order to create an upstand against the wall.

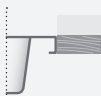

Onset - 4 Sides Down

The onset sink is formatted in a way that all four sides are folded down.

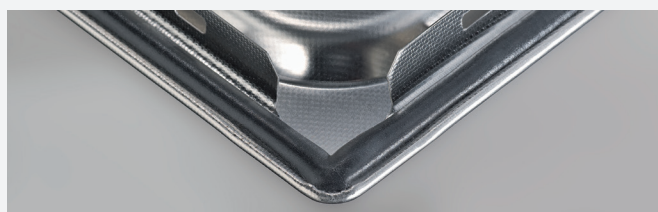

Factory fitted seal

PYRAMIS Stainless Steel Sinks for inset installation are provided with a preinstalled sealant of polyurethane underneath the sink, thus, the installation of an inset sink becomes much easier and friendlier since the sealant that is already installed provides time-saving compared to other sealing methods.

LIFETIME GUARANTEE

stainless steel
18/10
AISI 304

 PYRAMIS



Grando Series (Onset Type)

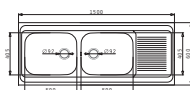

GRANDO (150X60) 2B 1D

Sink Dimensions: 150x60cm
Bowl Dimensions: 50x40cm / 50x40cm
Bowl Depth: 31cm / 31cm
Min. Base Unit: 110cm
Waste Valves: Ø92mm

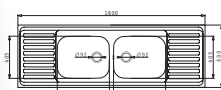

GRANDO (180X60) 2B 2D

Sink Dimensions: 180x60cm
Bowl Dimensions: 50x40cm / 50x40cm
Bowl Depth: 31cm / 31cm
Min. Base Unit: 110cm
Waste Valves: Ø92mm



GRANDO (200X60) 2B 2D

Sink Dimensions: 200x60cm
Bowl Dimensions: 50x40cm / 50x40cm
Bowl Depth: 31cm / 31cm
Min. Base Unit: 110cm
Waste Valves: Ø92mm

Profondo Series (Inset Type)

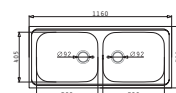

PROFONDO (116X50) 2B

Sink Dimensions: 116x50cm
Bowl Dimensions: 50x40cm / 50x40cm
Bowl Depth: 31cm / 31cm
Min. Base Unit: 110cm
Waste Valves: Ø92mm

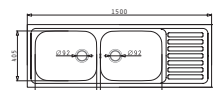

PROFONDO (150X51) 2B 1D

Sink Dimensions: 150x51cm
Bowl Dimensions: 50x40cm / 50x40cm
Bowl Depth: 31cm / 31cm
Min. Base Unit: 110cm
Waste Valves: Ø92mm



Iris Series (Undermount Type)

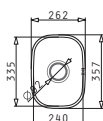

IRIS (24X33,5) 1B

Outer Dimensions: 26,2x35,7cm
Bowl Dimensions: 24x33,5cm
Bowl Depth: 15cm
Min. Base Unit: 30cm
Waste Valve: Ø92mm

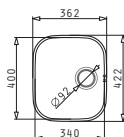

IRIS (34X40) 1B

Outer Dimensions: 36,2x42,2cm
Bowl Dimensions: 34x40cm
Bowl Depth: 18cm
Min. Base Unit: 40cm
Waste Valve: Ø92mm

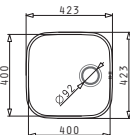

IRIS (40X40) 1B

Outer Dimensions: 42,3x42,3cm
Bowl Dimensions: 40x40cm
Bowl Depth: 20cm
Min. Base Unit: 45cm
Waste Valve: Ø92mm

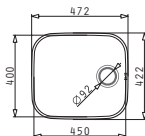

IRIS (45X40) 1B

Outer Dimensions: 47,2x42,2cm
Bowl Dimensions: 45x40cm
Bowl Depth: 20cm
Min. Base Unit: 50cm
Waste Valve: Ø92mm

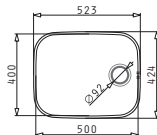

IRIS (50X40) 1B

Outer Dimensions: 52,3x42,3cm
Bowl Dimensions: 50x40cm
Bowl Depth: 20cm
Min. Base Unit: 45cm
Waste Valve: Ø92mm



Lume Series (Undermount Type)

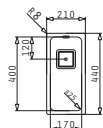

LUME (17X40) 1B

Outer Dimensions: 21x44cm
Bowl Dimensions: 17x40cm
Bowl Depth: 14cm
Min. Base Unit: 30cm
Waste Valve: Square

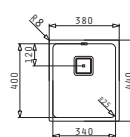

LUME (34X40) 1B

Outer Dimensions: 38x44cm
Bowl Dimensions: 34x40cm
Bowl Depth: 20cm
Min. Base Unit: 40cm
Waste Valve: Square

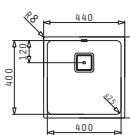

LUME (40X40) 1B

Outer Dimensions: 44x44cm
Bowl Dimensions: 40x40cm
Bowl Depth: 20cm
Min. Base Unit: 45cm
Waste Valve: Square

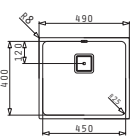

LUME (50X40) 1B

Outer Dimensions: 54x44cm
Bowl Dimensions: 50x40cm
Bowl Depth: 20cm
Min. Base Unit: 60cm
Waste Valve: Square

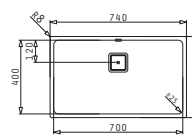

LUME (70X40) 1B

Outer Dimensions: 74x44cm
Bowl Dimensions: 70x40cm
Bowl Depth: 20cm
Min. Base Unit: 80cm
Waste Valve: Square

LIFETIME GUARANTEE

stainless steel
18/10
AISI 304

PYRAMIS



Lydia Series (Undermount Type)

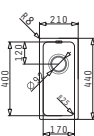

LYDIA (17X40) 1B

Outer Dimensions: 21x44cm
Bowl Dimensions: 17x40cm
Bowl Depth: 14cm
Min. Base Unit: 30cm
Waste Valve: Ø92mm

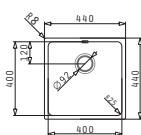

LYDIA (40X40) 1B

Outer Dimensions: 44x44cm
Bowl Dimensions: 40x40cm
Bowl Depth: 20cm
Min. Base Unit: 45cm
Waste Valve: Ø92mm

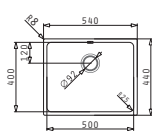

LYDIA (50X40) 1B

Outer Dimensions: 54x44cm
Bowl Dimensions: 50x40cm
Bowl Depth: 20cm
Min. Base Unit: 60cm
Waste Valve: Ø92mm

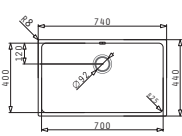

LYDIA (70X40) 1B

Outer Dimensions: 74x44cm
Bowl Dimensions: 70x40cm
Bowl Depth: 20cm
Min. Base Unit: 80cm
Waste Valve: Ø92mm

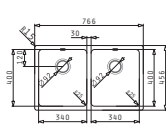

LYDIA (77X46) 2B

Outer Dimensions: 77,6x45,6cm
Bowl Dimensions: 34x40cm / 34x40cm
Bowl Depth: 20cm / 20cm
Min. Base Unit: 80cm
Waste Valves: Ø92mm



Relia Series (Undermount Type)

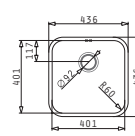

RELIA (40X40) 1B

Outer Dimensions: 43,6x43,6cm
Bowl Dimensions: 40,1x40,1cm
Bowl Depth: 18cm
Min. Base Unit: 45cm
Waste Valve: Ø92mm

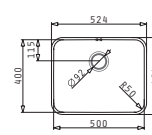

RELIA (50X40) 1B

Outer Dimensions: 52,4x42,4cm
Bowl Dimensions: 50x40cm
Bowl Depth: 18cm
Min. Base Unit: 60cm
Waste Valve: Ø92mm

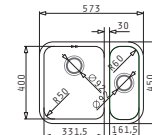

RELIA (57X45) 1 1/2B Left

Outer Dimensions: 57,3x45cm
Bowl Dimensions: 33,15x40cm / 16,15x40cm
Bowl Depth: 18cm / 12cm
Min. Base Unit: 60cm
Waste Valves: Ø92mm

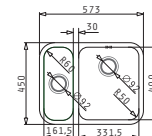

RELIA (57X45) 1 1/2B Right

Outer Dimensions: 57,3x45cm
Bowl Dimensions: 16,15x40cm / 33,15x40cm
Bowl Depth: 12cm / 18cm
Min. Base Unit: 60cm
Waste Valves: Ø92mm

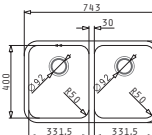

RELIA (74X45) 2B

Outer Dimensions: 74,3x45cm
Bowl Dimensions: 33,15x40cm / 33,15x40cm
Bowl Depth: 18cm / 18cm
Min. Base Unit: 80cm
Waste Valves: Ø92mm



Zeria Series (Flushmount Type)

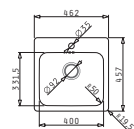

ZERIA (46,2X45,7) 1B

Sink Dimensions: 46,2x45,7cm
Bowl Dimensions: 40x33,15cm
Bowl Depth: 18cm
Min. Base Unit: 45cm
Waste Valve: Ø92mm

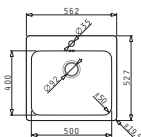

ZERIA (56,2X52,7) 1B

Sink Dimensions: 56,2x52,7cm
Bowl Dimensions: 50x40cm
Bowl Depth: 18cm
Min. Base Unit: 60cm
Waste Valve: Ø92mm

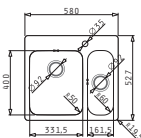

ZERIA (58X52,7) 1 1/2B Left

Sink Dimensions: 58x52,7cm
Bowl Dimensions: 33,15x40cm / 16,15x40cm
Bowl Depth: 18cm / 12cm
Min. Base Unit: 60cm
Waste Valves: Ø92mm

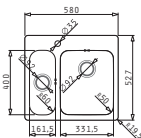

ZERIA (58X52,7) 1 1/2B Right

Sink Dimensions: 58x52,7cm
Bowl Dimensions: 16,15x40cm / 33,15x40cm
Bowl Depth: 12cm / 18cm
Min. Base Unit: 60cm
Waste Valves: Ø92mm

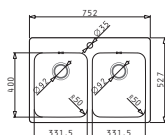

ZERIA (75,2X52,7) 2B

Sink Dimensions: 75,2x52,7cm
Bowl Dimensions: 33,15x40cm / 33,15x40cm
Bowl Depth: 18cm / 18cm
Min. Base Unit: 80cm
Waste Valves: Ø92mm

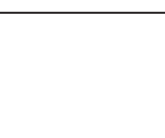
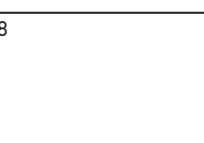

Basic Series (Inset Type)

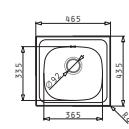

E33 (46,5X43,5)

Sink Dimensions: 46,5x43,5cm
Bowl Dimensions: 36,5x33,5cm
Bowl Depth: 15cm
Min. Base Unit: 40cm
Waste Valve: Ø92mm

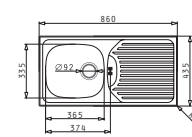

CA1 (86X43,5)

Sink Dimensions: 86x43,5cm
Bowl Dimensions: 36,5x33,5cm
Bowl Depth: 15cm
Min. Base Unit: 50cm
Waste Valve: Ø92mm

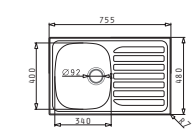

CRETA (75,5X48) 1B 1D

Sink Dimensions: 75,5x48cm
Bowl Dimensions: 34x40cm
Bowl Depth: 15cm
Min. Base Unit: 45cm
Waste Valves: Ø92mm



LIFETIME GUARANTEE

stainless steel
18/10
AISI 304

PYRAMIS



Space Series (Inset Type)

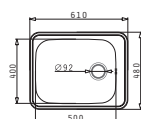

SPACE PLUS (61X48) 1B

Sink Dimensions: 61x48cm
Bowl Dimensions: 50x40cm
Bowl Depth: 21cm
Min. Base Unit: 60cm
Waste Valve: Ø92mm

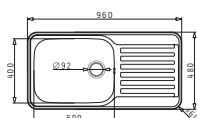

SPACE PLUS (96X48) 1B 1D

Sink Dimensions: 96x48cm
Bowl Dimensions: 50x40cm
Bowl Depth: 21cm
Min. Base Unit: 60cm
Waste Valve: Ø92mm

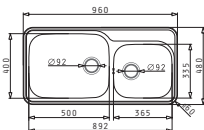

SPACE PLUS (96X48) 2B

Sink Dimensions: 96x48cm
Bowl Dimensions: 50x40cm / 36,5x33,5cm
Bowl Depth: 21cm / 15cm
Min. Base Unit: 100cm
Waste Valve: Ø92mm

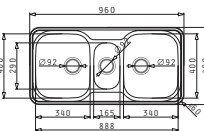

SPACE MINI (96X48) 2B

Sink Dimensions: 96x48cm
Bowl Dimensions: 34x40cm / 16,5x29cm / 34x40cm
Bowl Depth: 19cm / 13cm / 19cm
Min. Base Unit: 100cm
Waste Valve: Ø92mm



Tico Series (Inset Type)



MATERIAL THICKNESS 1,2mm!

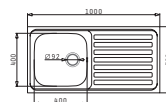

TICO (100X50) 1B 1D

Sink Dimensions: 100x50cm
Bowl Dimensions: 40x40cm
Bowl Depth: 21cm
Min. Base Unit: 50cm
Waste Valve: Ø92mm



MATERIAL THICKNESS 1,2mm!

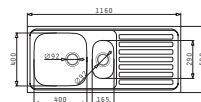

TICO (116X50) 1B 1D

Sink Dimensions: 116x50cm
Bowl Dimensions: 50x40cm
Bowl Depth: 21cm / 13cm
Min. Base Unit: 60cm
Waste Valves: Ø92mm



MATERIAL THICKNESS 1,2mm!

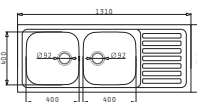

TICO (131X50) 2B 1D

Sink Dimensions: 131x51cm
Bowl Dimensions: 40x40cm / 40x40cm
Bowl Depth: 21cm / 21cm
Min. Base Unit: 90cm
Waste Valves: Ø92mm



Corner Series (Inset Type)

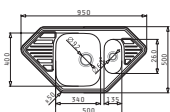

MEDUSA CORNER (96X50) 1 1/2B 2D

Sink Dimensions: 95x50cm
Bowl Dimensions: 34x40cm / 13,5x26cm
Bowl Depth: 19cm / 11cm
Min. Base Unit: 60cm
Waste Valves: Ø92mm / Ø60mm

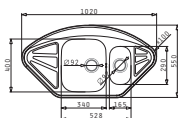

NEFELI (102X55) 1 1/2B 21D

Sink Dimensions: 102x55cm
Bowl Dimensions: 34x40cm / 16,5x29cm
Bowl Depth: 19cm / 13cm
Min. Base Unit: 60cm
Waste Valves: Ø92mm

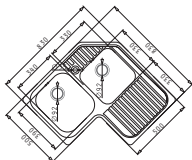

CELESTE (83X83) 2B 1D LH

Sink Dimensions: 83x83cm
Bowl Dimensions: 34x39cm / 33x33cm
Bowl Depth: 22cm / 22,5cm
Min. Base Unit: 80cm
Waste Valves: Ø92mm



Athena Series (Inset Type)

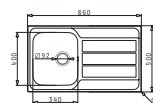

ATHENA EXTRA (86X50) 1B 1D

Sink Dimensions: 86x50cm
Bowl Dimensions: 34x40cm
Bowl Depth: 20cm
Min. Base Unit: 45cm
Waste Valves: Ø92mm

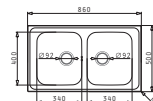

ATHENA (86X50) 2B

Sink Dimensions: 86x50cm
Bowl Dimensions: 34x40cm / 34x40cm
Bowl Depth: 20cm
Min. Base Unit: 80cm
Waste Valves: Ø92mm

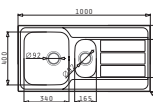

ATHENA (100X50) 1 1/2B 1D

Sink Dimensions: 100x50cm
Bowl Dimensions: 34x40cm / 16,5x29cm
Bowl Depth: 20cm / 14cm
Min. Base Unit: 60cm
Waste Valves: Ø92mm

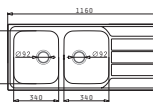

ATHENA EXTRA (116X50) 2B 1D

Sink Dimensions: 116x50cm
Bowl Dimensions: 34x40cm / 34x40cm
Bowl Depth: 20cm / 20cm
Min. Base Unit: 80cm
Waste Valves: Ø92mm

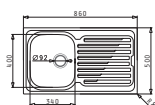

**Amaltia Series (Inset Type)****AMALTIA (86X50) 1B 1D**

Sink Dimensions: 86x50cm
Bowl Dimensions: 34x40cm
Bowl Depth: 19cm
Min. Base Unit: 45cm
Waste Valve: Ø92mm

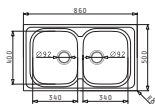
**AMALTIA / ARIADNE (86X50) 2B**

Sink Dimensions: 86x50cm
Bowl Dimensions: 34x40cm
Bowl Depth: 19cm / 19cm
Min. Base Unit: 80cm
Waste Valves: Ø92mm

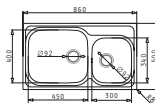
**AMALTIA PLUS (86X50) 2B**

Sink Dimensions: 86x50cm
Bowl Dimensions: 45x40cm / 30x34cm
Bowl Depth: 21cm / 18cm
Min. Base Unit: 90cm
Waste Valve: Ø92mm

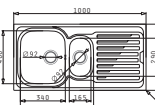
**AMALTIA (100X50) 1 1/2B 1D**

Sink Dimensions: 100x50cm
Bowl Dimensions: 34x40cm / 16,5x29cm
Bowl Depth: 19cm / 13cm
Min. Base Unit: 60cm
Waste Valves: Ø92mm

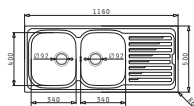
**AMALTIA (116X50) 2B 1D**

Sink Dimensions: 116x50cm
Bowl Dimensions: 34x40cm / 34x40cm
Bowl Depth: 19cm / 19cm
Min. Base Unit: 80cm
Waste Valves: Ø92mm

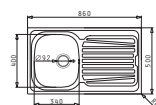
**Sparta Series (Inset Type)****SPARTA (86X50) 1B 1D**

Sink Dimensions: 86x50cm
Bowl Dimensions: 34x40cm
Bowl Depth: 16cm
Min. Base Unit: 45cm
Waste Valve: Ø92mm

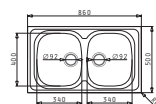
**SPARTA (86X50) 2B**

Sink Dimensions: 86x50cm
Bowl Dimensions: 34x40cm / 34x40cm
Bowl Depth: 16cm / 16cm
Min. Base Unit: 80cm
Waste Valve: Ø92mm

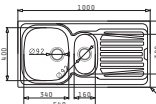
**SPARTA (100X50) 1 1/2B 1D**

Sink Dimensions: 100x50cm
Bowl Dimensions: 34x40cm / 16x30cm
Bowl Depth: 16cm / 10cm
Min. Base Unit: 60cm
Waste Valve: Ø92mm

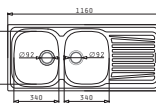
**SPARTA (116X50) 2B 1D**

Sink Dimensions: 116x50cm
Bowl Dimensions: 34x40cm / 34x40cm
Bowl Depth: 16cm / 16cm
Min. Base Unit: 80cm
Waste Valves: Ø92mm



Titan Series (Inset Type)

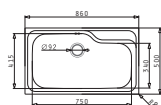

TITAN (86X50) 1B

Sink Dimensions: 86x50cm
Bowl Dimensions: 75x41,5cm
Bowl Depth: 21cm
Min. Base Unit: 90cm
Waste Valve: Ø92mm

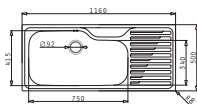

TITAN (116X50) 1B 1D

Sink Dimensions: 116x50cm
Bowl Dimensions: 75x41,5cm
Bowl Depth: 21cm
Min. Base Unit: 90cm
Waste Valve: Ø92mm



Bowl Series (Inset Type)

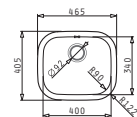

KIBA SQUARE (46,5X40,5) 1B

Sink Dimensions: 46,5x40,5cm
Bowl Dimensions: 40x34cm
Bowl Depth: 16cm

Min. Base Unit: 45cm
Waste Valve: Ø92mm

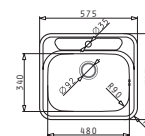

ATRIA (57,5X50,5) 1B

Sink Dimensions: 57,5x50,5cm
Bowl Dimensions: 48x34cm
Bowl Depth: 19cm

Min. Base Unit: 60cm
Waste Valve: Ø92mm

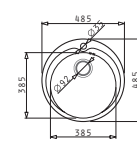

KIBA (Ø48,5) 1B

Sink Dimensions: Ø48,5cm
Bowl Dimensions: Ø38,5cm
Bowl Depth: 17,3cm

Min. Base Unit: 45cm
Waste Valve: Ø92mm

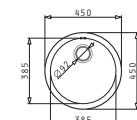

CR (Ø45) 1B

Sink Dimensions: Ø45cm
Bowl Dimensions: Ø38,5cm
Bowl Depth: 16cm

Min. Base Unit: 45cm
Waste Valve: Ø92mm

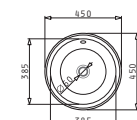

ROYAL

Sink Dimensions: Ø45cm
Bowl Dimensions: Ø38,5cm
Bowl Depth: 17cm

Min. Base Unit: 45cm
Waste Valve: Ø60mm

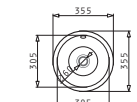

ROYAL MINI

Sink Dimensions: Ø35,5cm
Bowl Dimensions: Ø30,5cm
Bowl Depth: 18cm

Min. Base Unit: 40cm
Waste Valve: Ø60mm



LIFETIME GUARANTEE

stainless steel
18/10
AISI 304

Pyragranite Series (Inset Type)

Pyragranite sinks consist of 80% natural quartz (silica), while the remaining 20% of the mixture consists of resins and enhancing substances. You can find the PYRAMIS Pyragranite Sinks in 6 different colors. Underneath each model you can find included and other suitable valves and siphons.

Pyragranite sinks show high heat resistance even after contact with an object at 200°C. They can resist an impact of an 1kg object dropped from a height of 70cm. They also exhibit high hardness qualities, thus providing increased anti-scratch behavior. They do not discolor even if they come in contact with domestic cleaning kitchen products. Mold, stains and unpleasant smells are often caused by bacteria. Pyragranite homogenous, without pores, surface prevents bacteria accumulation making your sink cleaner and safer.

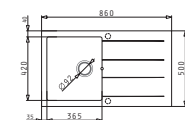

ATHLOS (86X50) 1B 1D

Sink Dimensions: 86x50cm
Bowl Dimensions: 36,5x42cm
Bowl Depth: 19.6cm
Min. Base Unit: 45cm
Waste Valve: Ø92mm

| Color | Ar. Number | Waste valve | Packaging |
|-----------|------------|-------------|---------------------|
| SNOW | 070038911 | Ø92mm | 1 Item / Carton Box |
| CARBON | 070039011 | Ø92mm | 1 Item / Carton Box |
| BEIGE | 070039111 | Ø92mm | 1 Item / Carton Box |
| MOCHA | 070039211 | Ø92mm | 1 Item / Carton Box |
| CHOCOLATE | 070039311 | Ø92mm | 1 Item / Carton Box |
| IRON GREY | 070039411 | Ø92mm | 1 Item / Carton Box |

Carton box includes: Waste valve & space saver siphon

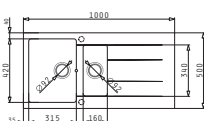

ATHLOS (100X50) 1 1/2B 1D

Sink Dimensions: 100x50cm
Bowl Dimensions: 31,5x42cm / 16x34cm
Bowl Depth: 19.6cm / 16cm
Min. Base Unit: 60cm
Waste Valve: Ø92mm

| Color | Ar. Number | Waste valves | Packaging |
|-----------|------------|--------------|---------------------|
| SNOW | 070010511 | Ø92mm | 1 Item / Carton Box |
| CARBON | 070010611 | Ø92mm | 1 Item / Carton Box |
| BEIGE | 070010711 | Ø92mm | 1 Item / Carton Box |
| MOCHA | 070010811 | Ø92mm | 1 Item / Carton Box |
| CHOCOLATE | 070038711 | Ø92mm | 1 Item / Carton Box |
| IRON GREY | 070038811 | Ø92mm | 1 Item / Carton Box |

Carton box includes: Waste valves & space saver siphon

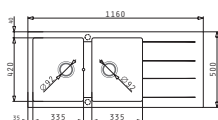

ATHLOS (116X50) 2B 1D

Sink Dimensions: 116x50cm
Bowl Dimensions: 33,5x42cm / 33,5x42cm
Bowl Depth: 20.5cm / 20,5cm
Min. Base Unit: 80cm
Waste Valve: Ø92mm

| Color | Ar. Number | Waste valves | Packaging |
|-----------|------------|--------------|---------------------|
| SNOW | 070039511 | Ø92mm | 1 Item / Carton Box |
| CARBON | 070039611 | Ø92mm | 1 Item / Carton Box |
| BEIGE | 070039711 | Ø92mm | 1 Item / Carton Box |
| MOCHA | 070039811 | Ø92mm | 1 Item / Carton Box |
| CHOCOLATE | 070039911 | Ø92mm | 1 Item / Carton Box |
| IRON GREY | 070042611 | Ø92mm | 1 Item / Carton Box |

Carton box includes: Waste valves & space saver siphon

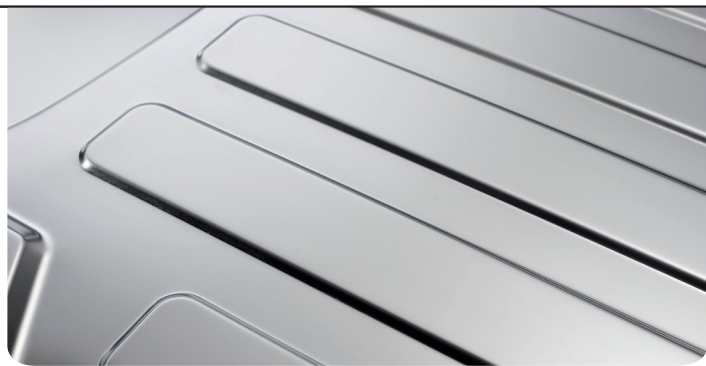

International Series (Onset Type)

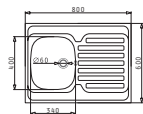

INTERNATIONAL (80X60) 1B 1D

Sink Dimensions: 80x60cm
Bowl Dimensions: 34x40cm
Bowl Depth: 16cm
Min. Base Unit: 45cm
Waste Valve: Ø60mm

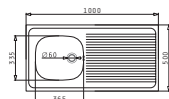

INTERNATIONAL (100X50) 1B 1D

Sink Dimensions: 100x50cm
Bowl Dimensions: 36,5x33,5cm
Bowl Depth: 16cm
Min. Base Unit: 45cm
Waste Valve: Ø60mm

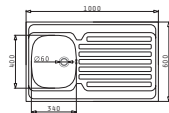

INTERNATIONAL (100X60) 1B 1D

Sink Dimensions: 100x60cm
Bowl Dimensions: 34x40cm
Bowl Depth: 16cm
Min. Base Unit: 45cm
Waste Valve: Ø60mm

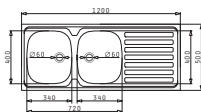

INTERNATIONAL (120X50) 2B 1D

Sink Dimensions: 120x50cm
Bowl Dimensions: 34x40cm / 34x40cm
Bowl Depth: 16cm
Min. Base Unit: 80cm
Waste Valve: Ø60mm

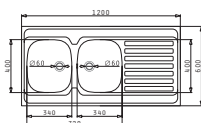

INTERNATIONAL (120X60) 2B 1D

Sink Dimensions: 120x60cm
Bowl Dimensions: 34x40cm / 34x40cm
Bowl Depth: 16cm
Min. Base Unit: 80cm
Waste Valve: Ø60mm

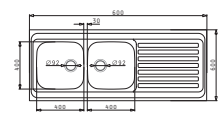

INTERNATIONAL (150X60) 2B 1D 40X40X20cm

Sink Dimensions: 150x60cm
Bowl Dimensions: 40x40cm / 40x40cm
Bowl Depth: 21cm
Min. Base Unit: 90cm
Waste Valve: Ø92mm

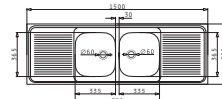

INTERNATIONAL (150X50) 2B 2D

Sink Dimensions: 150x50cm
Bowl Dimensions: 33,5x36,5cm/33,5x36,5cm
Bowl Depth: 16cm
Min. Base Unit: 85cm
Waste Valve: Ø60mm

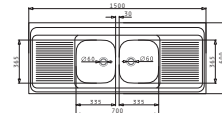

INTERNATIONAL (150X60) 2B 2D

Sink Dimensions: 150x60cm
Bowl Dimensions: 33,5x36,5cm/33,5x36,5cm
Bowl Depth: 16cm
Min. Base Unit: 85cm
Waste Valve: Ø60mm

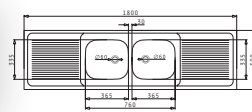

INTERNATIONAL (180X50) 2B 2D

Sink Dimensions: 180x50cm
Bowl Dimensions: 36,5x33,5cm/36,5x33,5cm
Bowl Depth: 16cm
Min. Base Unit: 85cm
Waste Valve: Ø60mm

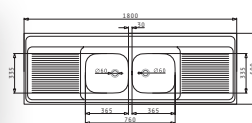

INTERNATIONAL (180X60) 2B 2D

Sink Dimensions: 180x60cm
Bowl Dimensions: 36,5x33,5cm/36,5x33,5cm
Bowl Depth: 16cm
Min. Base Unit: 85cm
Waste Valve: Ø60mm



Valves & Siphons



Waste valve
Ø60 with ring
stopper



Waste valve
Ø92



Square
waste valve



Waste valve
Ø60 with bowl
overflow



Waste valve
Ø92 with bowl
overflow

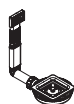

Square waste
valve with
rectangular
overflow



Waste valve Ø52
-Ø60 with round
bowl overflow



Pop up waste
valve Ø92 with
bowl overflow



Pop up square
waste valve
with rectangular
overflow



Siphon for sinks
with 1 bowl

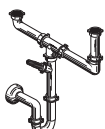

Siphon for sinks
with 1 1/2B



Siphon for sinks
with 2B

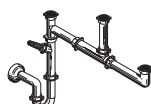

Siphon for sinks
with 2 1/2 bowls

Accessories

Stainless Steel 304 Round Soap Dispenser



Ar. Number

028102201

Capacity: 350ml

Stainless Steel 304 Colander with 1.5mm holes



Ar. Number

525007801

Colander Dimension: 42.5 x 20.5 cm
Depth: 15cm

Stainless Steel 304 Adjustable Colander

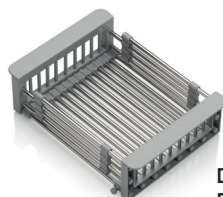

Ar. Number

525002001

Dimensions: 31.5 cm (up to 45.5 cm) x 21.5 cm
Depth: 7.5 cm

Waste Disposers

Classic Waste Disposer



Ar. Number

037000101

Power: 375W (1/2HP)
Diameter (mm): 179,9
Weight (kg): 3,8
Height (mm): 356,6
Motor Type: Magnetic
Volume Capacity (ml): 1100
Rotation Speed (r/min): 2600
Main Body Material: Antibacterial - Synthetic
Knife Material: Stainless Steel

Aluminum Flexible Tube

Aluminum Flexible Tube 5" (4M)
Aluminum Flexible Tube 5" (8M)
Aluminum Flexible Tube 6" (8M)



Stainless Steel 304 Square Soap Dispenser



Ar. Number

028102301

Capacity: 350ml

Stainless Steel 304 Colander with 0.5mm holes



Ar. Number

525001901

Colander Dimension: 42.5 x 20.5 cm
Depth: 15cm

Stainless Steel 304 Waste Valve with Basket



Ar. Number

521007801

Waste valve Ø92mm With Basket



Kitchen Taps

1. Cartridge

New type of cartridge that makes it possible to optimize consumption, avoid useless energy overloads and reduces noise significantly (Sound Free).

2. Aerator

Air Force aerators with flow limiters, small devices installed to the tap, which, by mixing water with air, allow up to 30% water saving, while obtaining a better flowjet (WRAS certified).

3. Certified Raw Material

Brass alloy of quality and composition in compliance with the highest international standards, and low lead levels according to the European Directives EN 1982:2000, EN 12165:99 & EN 12164:01 (Lead Approved).

4. Galvanization – Pure Water Process

An innovative and pioneering galvanization method that prevents the leaching of toxic metals, such as lead and nickel, in drinking water by Pure Water Process (EN 248).

5. Hoses – Components

Environmental friendly components made of non-toxic material that do not affect the taste or scent of water, with excellent mechanical properties, and certified according to the international quality standards NSF, KTW, DVGW (Scent Free, Taste Free).

Product Advantages

Pure Water Process, Certified Raw Materials, Water & Energy Saving, Aerators with flow reducers, Ceramic Discs, Components made of non-toxic materials

KELA

- Chrome
- Brushed
- Black Matte



Single lever mixer tap with ceramic disc mechanism & pull-out spray

AVIA

- Chrome
- Brushed
- Black Matte



Single lever mixer tap with ceramic disc mechanism & pull-out spray

CALI

- Chrome
- Brushed
- Black Matte



Single lever mixer tap with ceramic disc mechanism & pull-out spray

DONA

- Chrome
- Brushed
- Black Matte



Single lever mixer tap with ceramic disc mechanism & pull-out spray

ELMA

- Chrome
- Brushed
- Black Matte

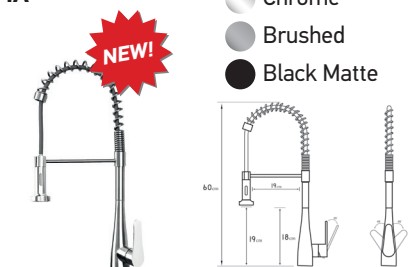

Single lever mixer tap with ceramic disc mechanism & pull-out spray

LEXI

- Chrome
- Brushed
- Black Matte

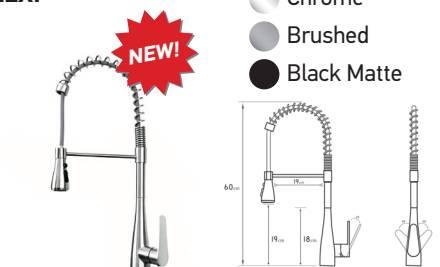

Single lever mixer tap with ceramic disc mechanism & pull-out spray

ADRIA

- Chrome

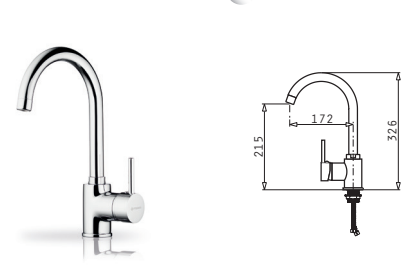

Single lever mixer tap with ceramic disc mechanism

ALEGRETO

- Chrome

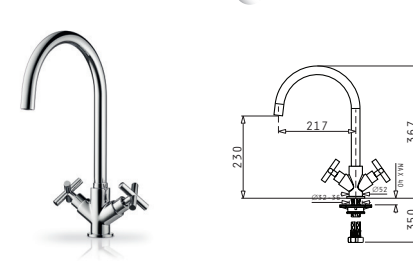

Dual lever mixer tap with ceramic disc mechanisms

GUSTO

- Chrome



Single lever mixer tap with ceramic disc mechanism

CALANTO

- Chrome

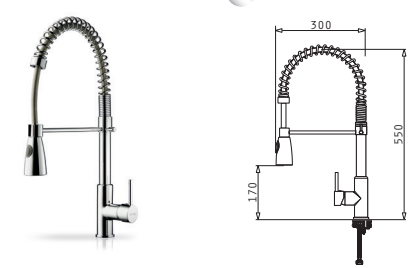

Single lever mixer tap with ceramic disc mechanism & pull-out spray

ARMONICA

- Chrome



Single lever mixer tap with ceramic disc mechanism

ALTISSIMO

- Chrome

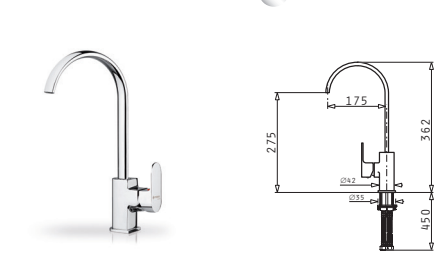

Single lever mixer tap with ceramic disc mechanism

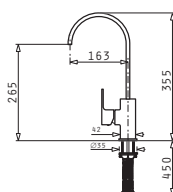
RISOLUTO
 Chrome

Single lever mixer tap with ceramic disc mechanism

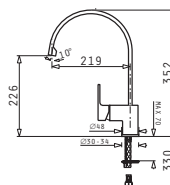
ARIOSO
 Chrome

Single lever mixer tap with ceramic disc mechanism

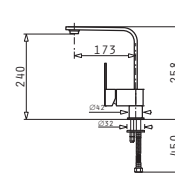
ESPRESSIVO
 Chrome

Single lever mixer tap with ceramic disc mechanism

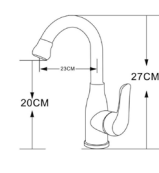
EPOQUE
 Chrome

Single lever mixer tap with ceramic disc mechanism

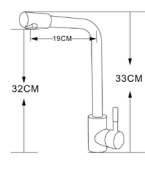
RISOLUTO
 Chrome

Single lever mixer tap with ceramic disc mechanism

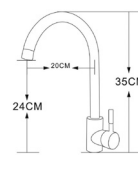
RALLENTA
 Chrome

Single lever mixer tap with ceramic disc mechanism

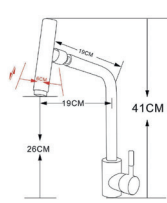
TUBA
 Chrome

Single lever mixer tap with ceramic disc mechanism & pull-out spray

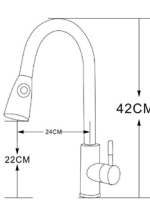
CAMPANA
 Chrome

Single lever mixer tap with ceramic disc mechanism & pull-out spray

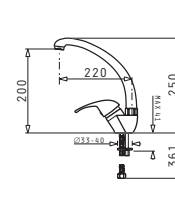
SERENO
 Chrome

Single lever mixer tap with ceramic disc mechanism

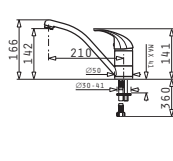
MODO
 Chrome

Long spout single lever mixer tap with ceramic disc mechanism

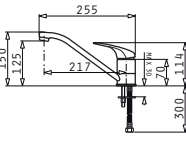
ACCEL
 Chrome

Long spout single lever mixer tap with ceramic disc mechanism

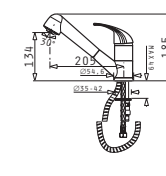
FESTIVO
 Chrome

Single lever mixer tap with ceramic disc mechanism & pull-out spray

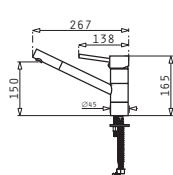
TRONTO
 Chrome

Single lever mixer tap with ceramic disc mechanism

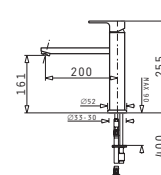
STRETO
 Chrome

Single lever mixer tap with ceramic disc mechanism



Microwave Oven 31 Inox

Code: 034017901
 Dimensions: 595x390x391mm
 Net Capacity: 25L
 Microwave Output Power (Watts): 900W
 Voltage/Frequency (Hz): 220V~60Hz

Cover: Silver
 Cavity: Stainless Steel
 Panel: Push Button
 Child Safety Lock: Yes



Microwave Oven 31 Black Glass

Code: 034018001
 Dimensions: 595x390x391mm
 Net Capacity: 25L
 Microwave Output Power (Watts): 900W
 Voltage/Frequency (Hz): 220V~60Hz

Cover: Black
 Cavity: Black
 Panel: Push Button
 Child Safety Lock: Yes



Oven 60IN 2180 Black Glass

Code: 034013201
 Dimensions: 595x575x595mm
 Net Capacity: 75L
 Max.rating power (W): 2800
 Number of Functions: 10

Control Type: Soft-touch
 Cooling Fan: Yes
 Layers of Door Glass: 3
 Inner Light (W): 15



Oven 60IN 2185 Black Glass & Inox

Code: 034013301
 Dimensions: 595x575x595mm
 Net Capacity: 75L
 Max.rating power (W): 2800
 Number of Functions: 10

Control Type: Soft-touch
 Cooling Fan: Yes
 Layers of Door Glass: 3
 Inner Light (W): 15



Built - In Refrigerator BBI 177

Code: 031000803
 Dimensions: 177 x 54 x 55cm
 Net Capacity: 256L
 Freezer: 73L
 Noise Level: 42dB
 Energy Efficiency: Class A

Double Door
 Automatic Defrosting
 4 Adjustable Tempered Glass Shelves
 Medical Compartment
 3 Drawer Compartment for Freezer
 2 Vegetable Drawer for Freezer
 Accessories: Ice Cubes & Ice Tray

GAS HOBS



2 Gas Burners Glass Hob with Aluminum Bar

| | |
|----------------------------------|----------------------------------|
| Code: 030030201 | Front Knob Control |
| Dimensions: 300x500mm | Cast Iron Pan Support |
| Cut-Out Size: 278x478mm | Aluminum Gas Valves |
| Rated Heat Flow (kw): 3.2 ; 1.65 | Under Knob Auto-Ignition Battery |
| 8mm Tempered Black Glass Panel | |

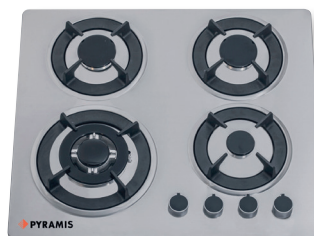

4 Gas Burners Stainless Steel Hob

| | |
|---|----------------------------------|
| Code: 030030601 | Front Knob Control |
| Dimensions: 580x500mm | Cast Iron Pan Support |
| Cut-Out Size: 560x480mm | Aluminum Gas Valves |
| Rated Heat Flow (kw): 3.2 ; 1.65 ; 1.65 ; 1.0 | Under Knob Auto-Ignition Battery |
| Stainless Steel Panel | |



4 Gas Burners Glass Hob with Aluminum Frame

| | |
|---|----------------------------------|
| Code: 030030701 | Front Knob Control |
| Dimensions: 580x500mm | Cast Iron Pan Support |
| Cut-Out Size: 545x465mm | Aluminum Gas Valves |
| Rated Heat Flow (kw): 3.2 ; 1.65 ; 1.65 ; 1.0 | Under Knob Auto-Ignition Battery |
| 8mm Tempered Black Glass Panel | |



4 Gas Burners Glass Hob with Aluminum Frame

| | |
|---|----------------------------------|
| Code: 030030901 | Front Knob Control |
| Dimensions: 860x510mm | Cast Iron Pan Support |
| Cut-Out Size: 840x480mm | Aluminum Gas Valves |
| Rated Heat Flow (kw): 3.2 ; 1.65 ; 1.65 ; 1.0 | Under Knob Auto-Ignition Battery |
| 8mm Tempered Black Glass Panel | |



Gas Hob 90CF INOX SQ Burners & Cast Iron

| | |
|--|----------------------------------|
| Code: 030030801 | Front Knob Control |
| Dimensions: 860x510mm | Cast Iron Pan Support |
| Cut-Out Size: 840x480mm | Aluminum Gas Valves |
| Rated Heat Flow (kw): 3.2 ; 2.6 ; 1.65 ; 1.0 | Under Knob Auto-Ignition Battery |
| Stainless Steel Panel | |

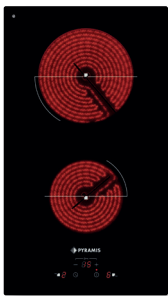

Ceramic Hob 2 Highlight Zone

| | |
|------------------------------|--------------------------------|
| Code: 174020010 | Timer: Yes |
| Dimensions: 290x510x50mm | Touch Control |
| Cut-Out Size: 490x270mm | Overflow Safety Device: Yes |
| Power: 1800W + 1200W | Safety Lock: Yes |
| Function Levels: 9 | Finish: Frameless, Black Glass |
| Residual Heat Indicator: Yes | |

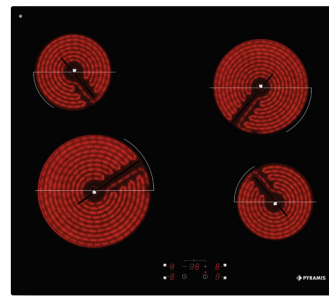

Ceramic Hob 4 Highlight Zone

| | |
|--------------------------------------|--------------------------------|
| Code: 174020030 | Timer: Yes |
| Dimensions: 580x510x50mm | Touch Control |
| Cut-Out Size: 560x490mm | Overflow Safety Device: Yes |
| Power: 1200W + 2300W + 1800W + 1200W | Safety Lock: Yes |
| Function Levels: 9 | Finish: Frameless, Black Glass |
| Residual Heat Indicator: Yes | |

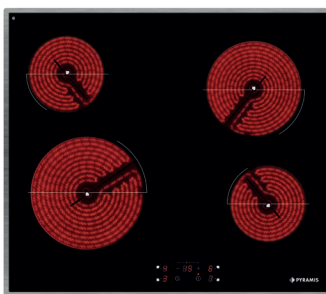

Ceramic Hob 4 Highlight Zone with INOX Frame

| | |
|--------------------------------------|---------------------------------|
| Code: 174020040 | Timer: Yes |
| Dimensions: 580x510x50mm | Touch Control |
| Cut-Out Size: 560x490mm | Overflow Safety Device: Yes |
| Power: 1200W + 2300W + 1800W + 1200W | Safety Lock: Yes |
| Function Levels: 9 | Finish: Inox Frame, Black Glass |
| Residual Heat Indicator: Yes | |

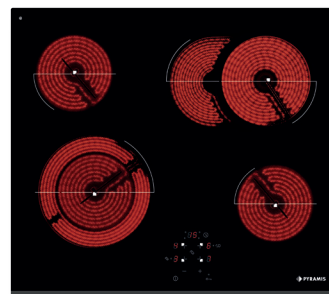

Ceramic Hob 6 Highlight Zone with Beveled Front

| | |
|--------------------------------------|------------------------------------|
| Code: 174020070 | Timer: Yes |
| Dimensions: 580x510x50mm | Touch Control |
| Cut-Out Size: 560x490mm | Overflow Safety Device: Yes |
| Power: 1200W + 2200W + 2200W + 1200W | Safety Lock: Yes |
| Function Levels: 9 | Finish: Beveled Front, Black Glass |
| Residual Heat Indicator: Yes | |

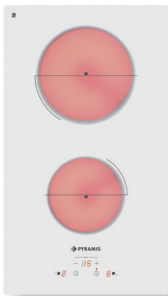

Ceramic Hob 2 Highlight Zone

| | |
|------------------------------|--------------------------------|
| Code: 174020020 | Timer: Yes |
| Dimensions: 290x510x50mm | Touch Control |
| Cut-Out Size: 490x270mm | Overflow Safety Device: Yes |
| Power: 1800W + 1200W | Safety Lock: Yes |
| Function Levels: 9 | Finish: Frameless, White Glass |
| Residual Heat Indicator: Yes | |

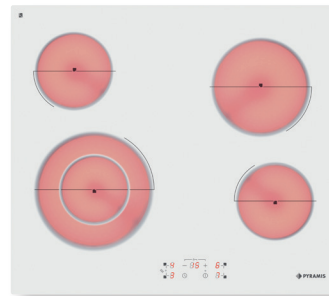

Ceramic Hob 5 Highlight Zone

| | |
|--------------------------------------|--------------------------------|
| Code: 174020050 | Timer: Yes |
| Dimensions: 580x510x50mm | Touch Control |
| Cut-Out Size: 560x490mm | Overflow Safety Device: Yes |
| Power: 1200W + 2200W + 1800W + 1200W | Safety Lock: Yes |
| Function Levels: 9 | Finish: Frameless, White Glass |
| Residual Heat Indicator: Yes | |

CERAMIC & INDUCTION HOBS

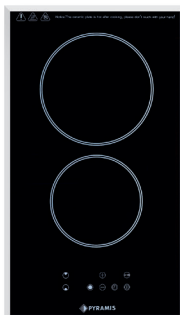

Ceramic Hob 29RD 232 Touch

| | |
|----------------------------------|--------------------------------------|
| Code: 030029601 | Sensor Touch Control |
| Dimensions: 300x520mm | Electronic 99 minute minder auto-off |
| Cut-Out Size: 275 x 495mm | LED Display |
| Power: 1800W + 1200W | Child Safety Lock |
| Power Supply: 220~240V - 50/60Hz | |
| A-Vitro Ceramic Glass | |

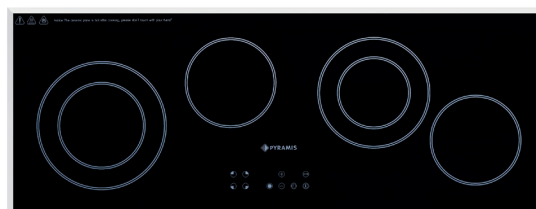

Ceramic Hob 90HL 634 Touch

| | |
|----------------------------------|--------------------------------------|
| Code: 030031001 | Power Supply: 220~240V - 50/60Hz |
| Dimensions: 900x350mm | A-Vitro Ceramic Glass |
| Cut-Out Size: 875x325mm | Sensor Touch Control |
| Power: (1100-2200W)+1200W + | Electronic 99 minute minder auto-off |
| (1100-1000W)+1200W | LED Display |
| Power Supply: 220~240V - 50/60Hz | Child Safety Lock |



Ceramic Hob 90HL 635 with Knob

| | |
|----------------------------------|--------------------------------------|
| Code: 030031101 | Power Supply: 220~240V - 50/60Hz |
| Dimensions: 900x350mm | A-Vitro Ceramic Glass |
| Cut-Out Size: 875x325mm | Front Knob Control |
| Power: (1100-2200W)+1200W + | Electronic 99 minute minder auto-off |
| (1100-1000W)+1200W | LED Display |
| Power Supply: 220~240V - 50/60Hz | Child Safety Lock |

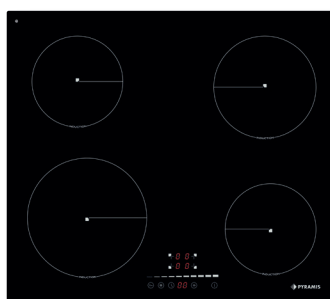

Induction Hob 4 Zones

| | |
|------------------------------------|------------------------------|
| Code: 174020080 | Residual Heat Indicator: Yes |
| Dimensions: 590x520x52mm | Timer: Yes |
| Cut-Out Size: 560x490mm | Touch Control |
| Power: (1800-2100W) + (1200-1400W) | Overflow Safety Device: Yes |
| (1500-1800W) + (1200-1400W) | Safety Lock: Yes |
| Function Levels: 9 | Finish: Frameless |

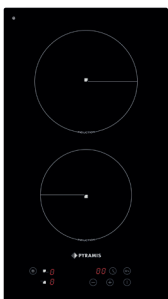

Induction Hob 2 Zones

| | |
|------------------------------------|------------------------------|
| Code: 174020090 | Residual Heat Indicator: Yes |
| Dimensions: 290x520mm | Timer: Yes |
| Cut-Out Size: 270x490mm | Touch Control |
| Power: (1800-2000W) + (1200-1500W) | Overflow Safety Device: Yes |
| Function Levels: 9 | Safety Lock: Yes |
| | Finish: Frameless |

Cookerhood Standard 60cm

Length: 60cm
 Airflow: 350m³/h
 3 Speed Motor
 Available Color: White - code: 065302501
 Brown - code: 065302601
 Voltage / Frequency: 220~240/50 V/Hz
 Input power: 160W
 Noise level: ≤54dB

Turbo Capacitor Motor
 Power: 60W
 Thickness: 0.6mm
 Type of Power Switch: Push Button
 Type of light / Power: 2×40 n° / W (Normal)
 Grease Filter: 2

Cookerhood Standard 90cm

Length: 90cm
 Airflow: 450m³/h
 3 Speed Motor
 Available Color: White - code: 065302801
 Brown - code: 065302901
 Inox - code: 065303001
 Voltage / Frequency: 220~240/50 V/Hz
 Input power: 160W

Noise level: ≤54dB
 Turbo Capacitor Motor
 Power: 60W
 Thickness: 0.6mm
 Type of Power Switch: Push Button
 Type of light / Power: 2×40 n° / W (Normal)
 Grease Filter: 2

Cookerhood Chimney 60cm

Code: 065303201
 Length: 60cm
 Airflow: 850m³/h
 3 Speed Motor
 Voltage / Frequency: 230/50 V/Hz
 Input power: 160W
 Noise level: 52dB

Turbo Capacitor Motor Power: 120W
 Thickness: 0.5mm
 Type of Power Switch: Push Button
 Type of light / Power: 2× 40 n° / W (Normal)
 Grease Filter: 2

Cookerhood Chimney 90cm

Code: 065303301
 Length: 90cm
 Airflow: 1000m³/h
 3 Speed Motor
 Voltage / Frequency: 230/50 V/Hz
 Input power: 160W
 Noise level: 52dB

Turbo Capacitor Motor Power: 120W
 Thickness: 0.5mm
 Type of Power Switch: Push Button
 Type of light / Power: 2× 40 n° / W (Normal)
 Grease Filter: 3

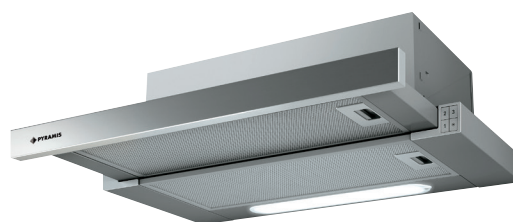
Sliding Hood

Size: 60cm
 Code: 065035101
 Voltage/Frequency: 220~240/50 (V/Hz)
 Input Power: 122W
 Lamp Power: 1x2W LED lamp n°x W
 Color: 430 Stainless Steel
 Airflow: 600m³/h
 Noise level: 60dB
 Type of Switch: 3 speeds rocker
 Speed: 3 levels
 Number of Motor: 1

Size: 90cm
 Code: 065035201
 Voltage/Frequency: 220~240/50 (V/Hz)
 Input Power: 122W
 Lamp Power: 1x2W LED lamp n°x W
 Color: 430 Stainless Steel
 Airflow: 700m³/h
 Noise level: 65dB
 Type of Switch: 3 speeds rocker
 Speed: 3 levels
 Number of Motor: 1

Curvo

Length : 90cm
 Airflow: 1000m³/h
 Available Color: Black - code: 065006601
 Red - code: 065023501
 White - code: 065023401
 Voltage / Frequency: 230/50 V/Hz
 Input power: 200W

Noise level: 52dB
 Sensor Touch Control
 Speed: 3 levels
 Metal blower box

COOKERHOODS



Curvo Plus

Code: 065032201
 Length: 90cm
 Airflow: 1000m³/h
 Power supply: 220-240V ~ 50/60Hz
 Motor power input: 200W

Speed: 3 levels
 Noise level: 56dB
 Sensor Touch Control
 With smoke sensor and remote
 Copper motor



Ombrello

Length : 90cm
 Airflow: 750m³/h
 Available Color: Black - code: 065006701
 White - code: 065023601
 Power supply: 220-240V ~ 50/60Hz
 Motor power input: 180W

Speed: 3 levels
 Noise level: 56dB
 Sensor Touch Control
 With smoke sensor
 and remote



Venero 60cm

Length : 60cm
 Extraction Rate (Ducted m³h): 550
 Available Color: Red - code: 065008601
 White - code: 065008401

Turbo capacitor: 120W
 Speed: 3 levels
 Noise level: 56dB
 Lamps / Power (n°xw):
 LED 2 x 1.5
 Control Type: Push Button



Venero 90cm

Length : 90cm
 Extraction Rate (Ducted m³h): 550
 Available Color: Red - code: 065008701
 White - code: 065008501
 Turbo capacitor: 120W

Speed: 3 levels
 Noise level: 56dB
 Lamps / Power (n°xw):
 LED 2 x 1.5
 Control Type: Push Button



Vetro 90cm

Code : 065006501
 Length : 90cm
 Airflow: 1000m³/h
 Power supply: 220-240V ~ 50/60Hz

Motor power input: 200W
 Speed: 3 levels
 Noise level: 56dB
 Sensor Touch Control
 With smoke sensor and remote



Vetro Plus 90cm

Code : 065032301
 Length : 90cm
 Airflow: 750m³/h
 Power supply: 220-240V ~ 50/60Hz

Motor power input: 180W
 Speed: 3 levels
 Noise level: 56dB
 Sensor Touch Control
 With smoke sensor and remote



PYRAMIS UAE L.L.C.

Ground Floor, Shop # 2, Al Fattan Bldg,
Industrial 1, Damascus St.,
Dubai, United Arab Emirates

Tel: (00971) 4-2632220 / (00971) 4-2503770

Email : pyramis@emirates.net.ae
Website: www.pyramisgroup.com

Dealers / Affiliates:

Assurance Trading Co. LLC
No. 31, Assurance Bldg., Ramlah Road, Old Ind. Area
Umm Al Quwain, United Arab Emirates
Tel: (00971) 6-7664122

Assurance Trading & Agencies

P.O. Box 30403, Abu Dhabi
United Arab Emirates
Tel: (00971) 2-5546440

Assurance TrCo-Br Shj

P.O. Box 41, Sharjah
United Arab Emirates
Tel: (00971) 6-5423020

Assurance Trading & Agencies

Saniya St. # 2, Al Ain
United Arab Emirates
Tel: (00971) 3-7211809

